

OWNER'S MANUAL

EXQ / EZQ / EXS Evaporative Coolers

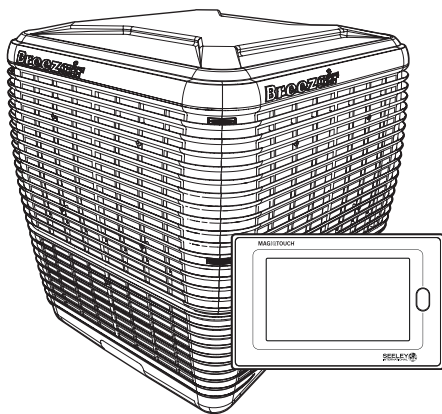
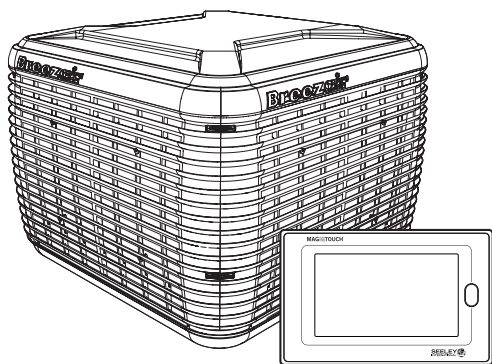

(English)

Hello and congratulations on purchasing a Breezair® evaporative cooler for your home.

At Seeley International we manufacture Breezair® evaporative coolers from the highest quality materials, and we have designed the product to provide many years of economical, trouble-free cooling.

Please take a few moments to read these operating instructions, so that the most can be gained from this investment. Keep these instructions in a safe place for future reference.

This Breezair® cooler is fitted with a MagIQtouch® controller. Please refer to the separate manual provided with the controller for instructions on how to set-up and operate this system.

This appliance is not intended for use by persons (including children) with reduced physical, sensory or mental capabilities, or lack of experience and knowledge, unless they have been given supervision or instruction concerning the use of the appliance by a person responsible for their safety. Children should be supervised to ensure they do not play with the appliance.

Important Notes!

In areas where temperatures can cause water supply pipes to freeze, a drain down facility should be provided during the installation. This drain down facility must be activated prior to freezing conditions, to avoid possible damage to the cooler components.

If the supply cord is damaged, it must be replaced by a Seeley service agent or similarly qualified person in order to avoid hazard.

New hose sets supplied with the appliance are to be used. Old hose sets (from previous installations) should not be re-used.

TABLE OF CONTENTS

OPERATING YOUR COOLER	3
MAGIQTOUCH CONTROLLER® SETTINGS MENU	3
About Appliance	3
Min/Max Set Temperature	3
Night Quiet Mode	3
Manual Drain	3
Pad Flush	3
Drain and Dry	3
AutoClean	3
WATERMISER®	4
DRAIN VALVE	4
BLEED SYSTEM	4
POWER OUTAGES	4
HEALTH REGULATIONS	5
MAINTENANCE	5
SEASONAL MAINTENANCE	5
Pre-Season	5
End of Season	5
REMOVING PAD FRAMES	6
MAINTENANCE SCHEDULE SERVICE CHECKLIST	7
TROUBLESHOOTING	8

OPERATING YOUR COOLER

To provide efficient cooling or ventilation the building must have sufficient exhaust openings to the outside of the building. To assist air flow, open windows and doors that are farthest from the outlet vent in each room. In these rooms, provide an exhaust opening about 2 times the vent size of the room.

Where the design of the building prevents adequate exhaust, consideration should be given to the provision of mechanical extractions, such as an exhaust fan.

There are three main ways that an evaporative cooler can operate to provide cooling comfort.

- The cooler can be set at a constant fan speed, without reference to the current temperature.
- The cooler can be given a temperature target, in which case it will vary the fan speed in order to get as close to the target as possible. (**Note!** Humid weather conditions may limit what temperatures can be achieved.)
- The cooler can be set to a fan only mode, providing air circulation only.

MAGIQTOUCH CONTROLLER® SETTINGS MENU

Your MagIQtouch Controller contains a settings menu which gives you access to information about your Breezair® evaporative cooler and to extra functions including:

About Appliance

Displays information such as model number, serial number and software version for all coolers connected to the controller.

Min/Max Set Temperature

Defines the maximum and minimum temperature values.

Night Quiet Mode

Restricts fan speed to a specified level during a specified night period.

Manual Drain

Turns cooler off and drains the tank.

Pad Flush

Turns cooler off and runs pump for a specified amount of time.

Drain And Dry

Cooler will drain and fan will run for 1 hour every day at a specified time.

Autoclean

Select the preferred cleaning interval (50 / 100 / 200 hrs). At 8.00am after the selected running hours has been reached, the cooler will drain the tank, fill with fresh water and operate the pump for 5 minutes. When complete, drains the tank and returns to previous operation mode.

Note! There are some settings that are just for trained service agents or installers. You won't be able to access any of these options without a pin code.

WATERMISER®

Breezair® evaporative coolers are fitted with the WaterMiser® feature which automatically monitors the quality of the water in the cooler.

The WaterMiser® drains the existing water in the cooler to allow it to be replaced with fresh water, only when it is needed. Therefore, you may notice your cooler draining water occasionally. How often the WaterMiser® performs this operation depends upon the quality of the water supply and the rate of evaporation. In areas of poor water quality, the WaterMiser® will operate more often as it tries to maintain the optimum water quality in the cooler. This maximises the cooling effect and life of the cooling pads.

The WaterMiser® allows you to specify either high or low salinity settings. The low salinity setting is used in specific circumstances only. We recommend talking with your dealer before adjusting this setting.

The high salinity setting is designed to operate the cooler at a maximum safe salinity level to maintain a normal working life. It also results in a minimum usage of water.

Note! High salinity outlet water can be used on saline tolerant gardens, but should not be used on salt sensitive grasses or plants.

The factory default WaterMiser® setting is HI. For areas operating with bore water, WaterMiser® should be switched to off.

This will disable the salinity measuring circuit and simply drain water from the tank every 65 minutes of operation.

DRAIN VALVE

Your cooler has been installed with a drain valve. It is accompanied by the WaterMiser® salinity probes. When the tank's water salinity level reaches a preset level the WaterMiser® will open the drain valve and release saline water. Fresh water will then be added diluting any minerals or salts accumulated. The WaterMiser® will continue to monitor and drain water as required.

Alternatively, the cooler can be set to drain saline water at a preset period of pump operating time. This can be set by changing the salinity control method selector via the Cooler settings screens.

Note! When the cooler's tank is empty and the cooler is turned on again, the fan operation will be delayed as the tank is refilled and the pads are saturated.

BLEED SYSTEM

If fitted, the bleed system will constantly drain small amounts of water during the operation of the cooler. This allows fresh water to be added diluting any minerals and salts accumulated.

The bleed rate for your cooler will depend on local operating conditions and will be set by the installer.

POWER OUTAGES

After a power outage the MagIQtouch Controller will prompt you to enter the date and time.

If the AUTO RESTART option is switched on in the SETTINGS menu, the following actions will result:

- If the cooler was last running in MANUAL mode, it will automatically restart only after the date and time have been confirmed.
- If the cooler was last running in PROGRAM mode, it will automatically restart, even before the time and date have been set, according to the last time recorded before the power outage.

HEALTH REGULATIONS

In some states, regulations require that evaporative air coolers be serviced at specific intervals.

MAINTENANCE

WARNING! As your cooler is mounted on the roof, we suggest that any maintenance or checks be carried out by an authorised Seeley International dealer or service agent. Climbing onto the roof can be hazardous and could result in injury to you and damage to your property.

Maintenance Schedule servicing is essential to ensure the cooler operates efficiently for many years. The following pages outline the suitable maintenance requirements to ensure that your cooler continues to operate efficiently.

We require that the following components and the operation thereof, be checked after the first year, then every 2 years as Maintenance Schedule servicing. Refer to the full checklist on Page 7.

- Water distribution spreader trays.
- Pump.
- Drain valve.
- Solenoid and associated filter / fittings.
- Fan motor operation.
- Float valve.
- Salinity probes etc

Maintenance Schedule servicing should be performed before the summer season. It is important to note that all evaporative coolers have components that may need periodic replacement (eg. filter pads, hoses, o-rings etc).

Note! Failure to carry out the Maintenance Schedule services will affect your warranty coverage.

Note! Maintenance Schedule servicing may be required more frequently in adverse environmental situations or where the appliance is installed in non-domestic applications. Please consult with the installer or service personnel to determine if more frequent servicing is required.

SEASONAL MAINTENANCE

Seasonal Maintenance is only required if you have a cooler fitted with a bleed system. If your cooler is fitted with a drain valve, no Seasonal Maintenance is required.

Seasonal Maintenance services must be performed before and after the summer season.

Pre-Season

1. Remove the pad frames as shown on the next page.
2. Ensure the power is off at the isolating switch inside the cooler.
3. Gently wash the pad frames to remove any dust build up during the winter. Note! Do not wash the pads with high pressure water spray. If pads are salted-up, replace them.
4. Check for water leaks. Check operation of float valve.
5. Turn on the water supply to the cooler.
6. Switch on the isolating switch.
7. Refit the pad frames.
8. Run the cooler.

WARNING! Ensure pad frames are fitted when operating the cooler.

End of Season

1. Turn off the water supply to the cooler.
2. Remove the pad frames
3. Turn off the power at the isolating switch inside the cooler.
4. Check and clean the water distributing spreader tray channels under the lid.
5. Drain the tank.
6. Thoroughly clean the tank, pump filter and salinity probe (if fitted).
7. Refit the pad frames.

REMOVING PAD FRAMES

To remove a pad frame:

1. Remove the clips holding the pad frame in place.
2. Insert a flat head screw driver into the slot between the lid and the top of the pad frame. Lever it so the pad frame is released.
3. Take hold of the pad frame, pivot it outwards and lift it up. Be careful not to damage the pad.

EZQ

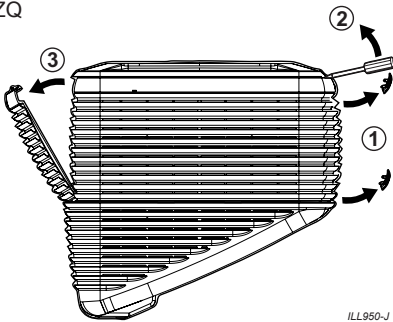

ILL.950-J

EXQ / EXS

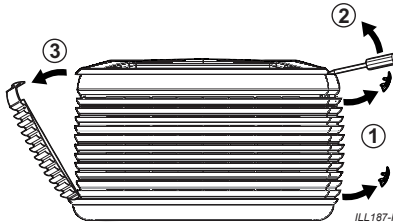

ILL.187-K

PAD FRAME POSITIONS

When re-fitting pads, ensure that they are fitted in their original positions. EXQ210, EZQ215 and all EXS model coolers have pads that vary from the standard 90mm thickness. While removing the pad frames, take note of the location each belongs to.

Check for stickers indicating correct locations for thick or cut edge pads.

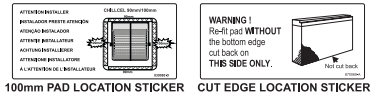
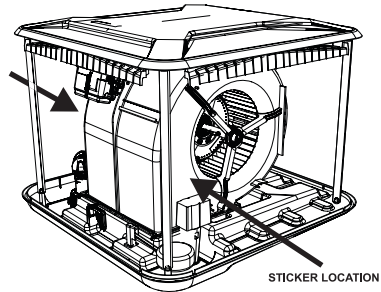

Stickers adhered to the fan scroll indicate the correct position.

If fitted incorrectly they may cause problems:

- Thicker pads may catch on internal components causing damage.
- Thicker pads may impede the correct operation of the float valve.
- Incorrect positioning of pads may cause a drop in cooler performance.
- Incorrect fitment may allow water to bypass the pad and be carried over into the air stream and ducting.
- Water bypass may cause damage to internal electronic components.

MAINTENANCE SCHEDULE SERVICE CHECKLIST

Service Item	Check/Adjust					Clean					Replace				
	1	2	3	4	5	1	2	3	4	5	1	2	3	4	5
Water Distribution System															
Chillcel Pads (replace as required)															
Pad Retaining Washers/Pins															
Tank/Water Reservoir															
Pump Filter															
Water Probes															
System Washers, Seals and O'Rings (replace as required)															
Drain Valve/Bleed Funnel operation															
Component Function															
Pump operation															
Drain Valve operation															
Motor Operation															
Solenoid operation															
Wall Control operation															
General Operation															
Water Level Set Point															
Water Fill Time															
Water Drain Time															
Water Distribution across Pads															
Airflow through system/Outlets															
General Product condition (includes correct fitting of all components and items - replace as required)															

Service No.	Service Date	Service Technician	Service Company
No.1
No.2
No.3
No.4
No.5

TROUBLESHOOTING

Symptom	Cause	Action
Unpleasant odour	Odour from the new pads	<ul style="list-style-type: none"> Use the 'Pad Flush' function in the SETTINGS menu of your Controller to flush pads. Fill tank, run pump for a short period to wash pads, drain tank, refill and repeat several times if odour persists. Odour will dissipate after a number of hours of operation.
Inadequate cooling	Dry pads	Ensure the water supply is turned on. Then check the water flow to the pads.
	Insufficient exhaust openings for conditioned air	Ensure sufficient exhaust openings.
	Excessive ambient humidity	On days during the summer when the ambient humidity is high, the cooler will not reduce the temperature as much as on drier days.
Cooler turns ON and OFF	Fault in the cooler	Contact the Dealer or Service number.

If your MagIQtouch Controller prompts you to call a service agent, please contact your local Dealer or the Service number on the back of this manual.

**When you contact your Dealer regarding service or warranty
please quote the cooler model number as shown below.**

Affix serial & model
numbers sticker here



Warranty Service
Australia 1-300-650-644
seeleyinternational.com

It is the policy of Seeley International to introduce continual product improvement.
Accordingly, specifications are subject to change without notice.
Please consult with your dealer to confirm the specifications of the model selected.

Breezair[®]
NUMBER ONE IN NATURAL COOLING

seeleyinternational.com