



# INSTALLATION MANUAL

## MagIQtouch Controller



# TABLE OF CONTENTS

<b>CABLE LENGTHS</b>	<b>1</b>
<b>MOUNTING THE MAGIQTOUCH CONTROLLER</b>	<b>2</b>
<b>CONNECTING THE MAGIQTOUCH CONTROLLER</b>	<b>8</b>
SINGLE COMPONENT INSTALLATION (NO ZONES)	8
MULTIPLE COMPONENT INSTALLATIONS	10
<b>OPERATION SCREENS</b>	<b>11</b>
<b>SETTINGS MENU</b>	<b>13</b>
<b>GENERAL MENU</b>	<b>15</b>
<b>COOLER &amp; HEATER MENUS</b>	<b>16</b>
<b>SERVICE MENU</b>	<b>16</b>
<b>CONTROLLER OR SYSTEM RESET</b>	<b>19</b>
<b>MANAGING COMPONENTS</b>	<b>20</b>
ADDING COMPONENTS	20
REPLACING COMPONENTS	21
REMOVING COMPONENTS	22
<b>MANAGING THE MAGIQTOUCH CONTROLLER</b>	<b>24</b>
CONNECTING A NEW CONTROLLER TO AN EXISTING SYSTEM	24
CONNECTING A PRE-USED CONTROLLER	25
<b>FAULT ROUTINE</b>	<b>26</b>
<b>SLAVE CONTROLLERS</b>	<b>28</b>
<b>POWER OUTAGES</b>	<b>29</b>
<b>TROUBLE SHOOTING</b>	<b>29</b>

## CABLE LENGTHS

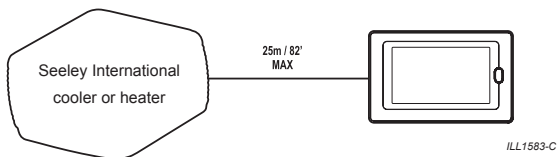

- Cables used for the MagIQtouch Controller are 26AWG, 7/0.16, 6 core flat.
- 20m/66' cable is supplied with each Seeley cooler or heater.
- Supplied cables should not be altered.

**ALWAYS** route cables at least 300mm/12" away from regular power cables and high power machines. Cross over power cables at right angles.

**Important!** The maximum cable length allowed from the MagIQtouch Controller to the first cooler is 25 metres/82'. For any additional coolers added into the system with a link module the maximum allowed length is 40 metres/131'. Therefore, failure of the product or components to operate correctly due to modification to supplied cables, or the use of non-approved cables will **NOT** be accepted under the Manufacturer's Warranty.

We have this cable available through our Sales order office and spare parts outlets in the following lengths:

Part No.	Length	Details
833880	20m/66'	MagIQtouch Controller Cable (No Ferrite)
823553	20m/66'	MagIQtouch Controller Cable EXQ/EXS (With Ferrite)
862873	1.5m/5'	MagIQtouch Controller Cable (No Ferrite)
861265	3m/10'	MagIQtouch Controller Cable (No Ferrite)
864396	30m/98'	MagIQtouch Controller Cable EXQ/EXS (With Ferrite)
864402	40m/131'	MagIQtouch Controller Cable EXQ/EXS (With Ferrite)

**Note!** The term "component" (Seeley International cooler or heater) will be used in this document to describe any separate device, such as a cooler, heater or sensor, which is to be connected to the MagIQtouch Controller.

## MOUNTING THE MAGIQTOUCH CONTROLLER

The MagIQtouch Controller should be placed approximately 1.5 metres/5' above the floor, in the most used room of the home.

Placement is critical for correct functioning of the temperature sensing thermostat inside the Controller.

The following points must be taken into consideration:

- Avoid direct sunlight exposure.
- Avoid mounting on external walls.
- Avoid mounting the wall control near heat sources such as stoves and televisions.
- Do not locate in the direct airflow of the duct outlets.
- Do not locate in strong drafts or in dead spots such as cupboards/drawers.
- Always seal the cable entry hole. Hot or cold air coming through the wall may interfere with the temperature measurement.

### CAUTION!

**Always make sure there are no electrical cables, gas or water pipes, or the like, behind where you intend to drill.**

## MOUNTING THE MAGIQTOUCH CONTROLLER cont

Remove the mounting bracket from the rear of the MagIQtouch Controller.

### STEP 1

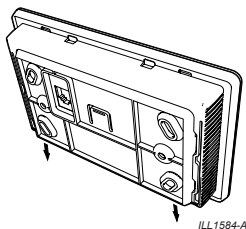

### STEP 2

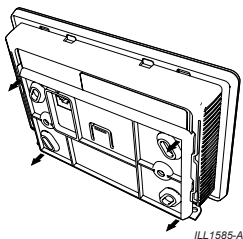

### STEP 3

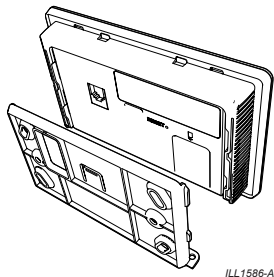

## MOUNTING THE MAGIQTOUCH CONTROLLER cont

Using the bracket as a template, mark the centre points for the screw and cable access holes.

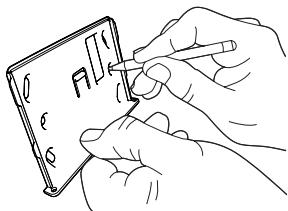

ILL1587-A

**Important!** The cable hole should be positioned centrally within the rectangular window in the mounting bracket.

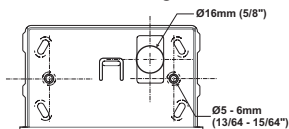

ILL1597-B

Drill a 16mm (5/8") hole for cable access, and two smaller holes for the wall plugs provided (5mm (13/64") holes for plasterboard walls or 6mm (15/64") holes for brick walls).

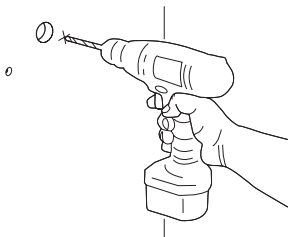

ILL1588-A

## MOUNTING THE MAGIQTOUCH CONTROLLER cont

Insert wall plugs into holes. Align and screw the bracket into position using the supplied screws.

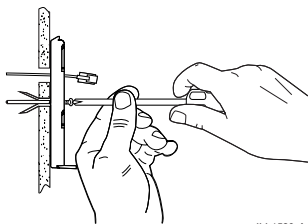

ILL1589-A

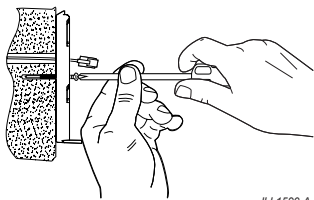

ILL1590-A

Alternatively, a standard stud mounting bracket (used for wall plates) can be used with plasterboard walls.

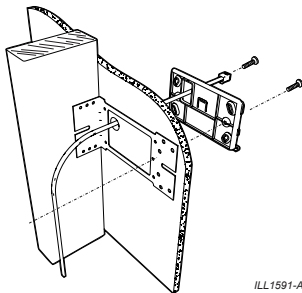

ILL1591-A

## MOUNTING THE MAGIQTOUCH CONTROLLER cont

Draw the cable through the wall cavity to the hole made at the wall bracket. Connect the cable to the wall control and mount the wall control onto its bracket.

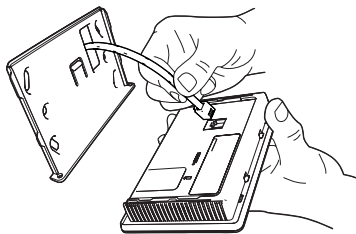

ILL1592-A

**Important!** Take care not to damage the cable or plug during this process.

**Important!** Drafts within the wall cavity can impact the temperature reading of the wall control. We recommend that the cable access hole be sealed, but in such a way that the cable can still retreat into the wall cavity.



## MOUNTING THE MAGIQTOUCH CONTROLLER cont

Slide and align the wall control over the protruding bracket tabs. Pull the wall control down so the bracket tabs engage and locate with the keyway slots on the rear.

### STEP 1

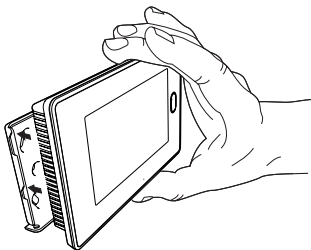

ILL1593-A

### STEP 2

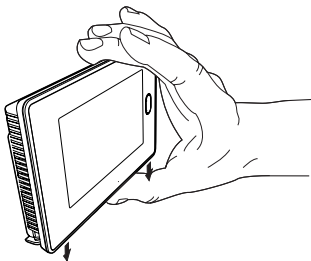

ILL1594-A

# CONNECTING THE MAGIQTOUCH CONTROLLER

## SINGLE COMPONENT INSTALLATION (NO ZONES)

Ensuring the MagIQtouch Controller is properly connected power up the heater/cooler.

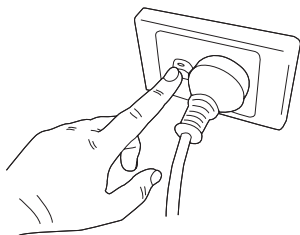

ILL1595-A

To activate the MagIQtouch Controller screen, press the button to the right.

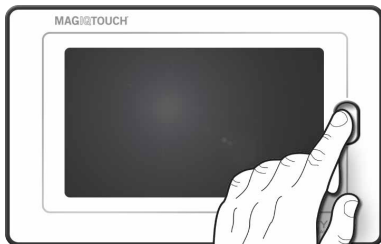

ILL1521-B

**Note!** The following images are examples only of some of the screens that may be displayed in the System Installation Process. The content and sequence of these screens may differ slightly on the Controller itself. Always follow the instructions displayed on the Controller itself.

## CONNECTING THE MAGIQTOUCH CONTROLLER cont

For a new installation, select “ALL NEW SYSTEM” option. This will start the “System Installation Wizard” which will step you through the complete process.



ILL1610-A

At the beginning of the “System Installation Wizard”, the Controller will ask for a definition of the system to be installed.

Start by selecting either “DEFAULT SINGLE COMPONENT” when installing a single heater or single cooler with no additional components, or “MULTIPLE COMPONENTS” for any other system types.



ILL1611-B

# CONNECTING THE MAGIQTOUCH CONTROLLER cont

## SINGLE COMPONENT INSTALLATION (NO ZONES)

**Important!** Ensure the heater or cooler is connected and powered up before proceeding! When prompted, the MagIQtouch Controller will do a scan to find the component (heater/cooler).

If no component is found, the MagIQtouch Controller will display the error. Check connections and power and RETRY.

If successful, the MagIQtouch Controller will display what it has found for confirmation. Selected CONTINUE to proceed to the operation screen.

Skip now to the 'OPERATION SCREENS' chapter.

## MULTIPLE COMPONENT INSTALLATIONS

The MagIQtouch Controller uses a 'System Installation Wizard' to assist with the installation process.

The first part of the wizard requires the installer to specify the type and number of components that will be installed in the system. This step is important because the MagIQtouch Controller needs components to be connected and powered up **one at a time** and **in the correct order**.

**Note!** It is important that components (e.g. heaters, coolers, sensors etc.) are connected **ONE AT A TIME** as prompted by the MagIQtouch Controller. If more than one component of the same device type is connected at the same time there is a risk of communication corruption and the system will not function correctly!

The system installation is complete once all components have been detected.

# OPERATION SCREENS

Select primary mode (COOL/HEAT/FAN ONLY):



ILL1613-B

Turn system on & off:



ILL1614-B

Adjust temperature:

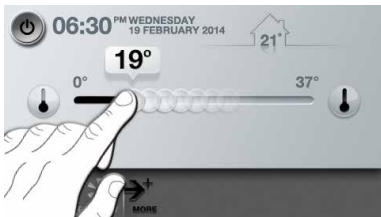

ILL1615-B

## OPERATION SCREENS cont

Access advanced display:



ILL1616-B

Choose between MANUAL or PROGRAM modes or access SETTINGS menu:



ILL1617-B

For detailed information on the operation screens refer to the MagIQtouch Controller Owner's Manual.

## SETTINGS MENU

The SETTINGS menu contains a GENERAL menu relating to the MagIQtouch Controller and the system as a whole, COOLER and HEATER menus depending on what has been installed, and a SERVICE menu containing component details and fault information.

**Note!** The Controller will only display the menus and menu items that are relevant to the installed system.

Navigate through the menus by tapping the heading tabs at the top of the screen.



ILL1618-A



ILL1619-A

All the menu items are listed on the left hand side of the screen.



ILL1620-B

## SETTINGS MENU cont

The current status is listed on the right, close to the arrow buttons.

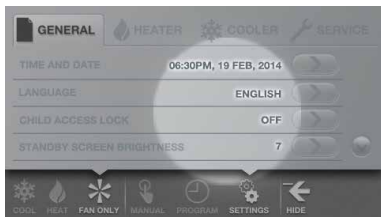

ILL1599-B

If you want to change a setting or access a menu item, press the arrow button.



ILL1621-B

Some menu items are locked with a pin code to discourage customer access. The pin code is 7378.



ILL1622-A



# GENERAL MENU

The GENERAL menu includes settings or information related to the MagIQtouch Controller, or the system as a whole.



ILL1623-B

- Time and Date.
- Language.
- °C / °F (temperature unit).
- Child Access Lock (set a pin to restrict access).
- Standby Screen Brightness (adjust standby screen brightness).
- Zone Renaming (customise zone names).
- Status Information Display (for troubleshooting & diagnostics).
- Temperature Sensor Selection (select between Controller or Master Air Sensor).
- Software Revision.
- Simple Mode Lock (lock screen to simple display).
- Shutdown Timer.
- Auto Re-start.
- Temperature Calibration.
- Install Add-On Cooler.
- System Configuration.
- System Reset.

## COOLER & HEATER MENUS

The COOLER and HEATER menus include settings or information related to the specific Seeley International cooling or heating products installed within the system.

More information about the specific settings of these products is provided in the separate product installation guide.

## SERVICE MENU

The SERVICE menu contains information and functions for competent service personnel.



ILL1624-B

Access is locked with a service pin code. The pin code is 7378.



ILL1625-A

## SERVICE MENU cont

Once the pin code is entered you will have access to component specific information such as model number, serial number, etc.

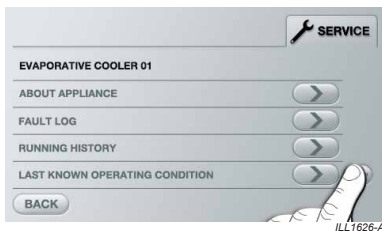

Also included in this menu is access to a 'Service Operating Screen' for each component installed in the system. This screen can be used as a troubleshooting tool.

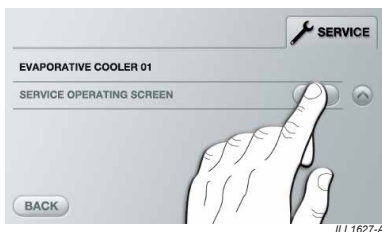

On this screen the status of the component is displayed and can be modified.

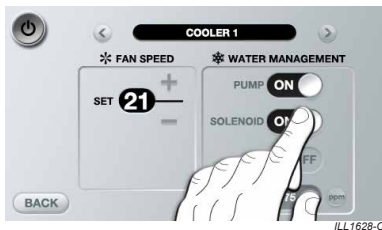

## SERVICE MENU cont

Other components of the same type can be accessed by using the scroll left/right buttons.



ILL1629-C

To access components of a different type, go BACK to the first SERVICE screen where all components are listed and select a different component.



ILL1630-A

Navigate through the menu as before until you reach the 'Service Operating Screen'.



ILL1631-B

## CONTROLLER OR SYSTEM RESET

It is possible to reset the whole system (including all connected components) or the MagIQtouch Controller only.

Use a pin or paperclip to press and hold the reset button located at the back of the Controller.

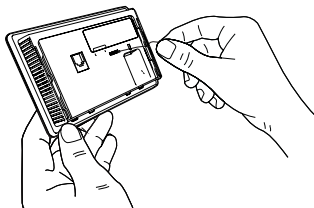

ILL1596-A

This will cause the following screen to appear:



ILL1632-A

**Note!** Resetting the whole system will mean that every component connected to the wall control will be given the factory default address. After resetting a whole system it will be necessary to go through the 'System Installation Wizard' again from the start.

# MANAGING COMPONENTS

## ADDING COMPONENTS

The MagIQtouch Controller keeps a list of all the installed components and regularly checks that all components are responding.

To add a new component, simply connect it to the system and power up. The Controller will detect that a new component has been added and lead you through the set-up process.

**Important!** It is important that new components of the same type are connected **ONE AT A TIME**.



ILL1633-A

## MANAGING COMPONENTS cont

### REPLACING COMPONENTS

To replace a faulty component with a new one, disconnect the old component. The MagIQtouch Controller will display a warning message (unless the component has previously been ignored).

Choose the 'IGNORE' option.

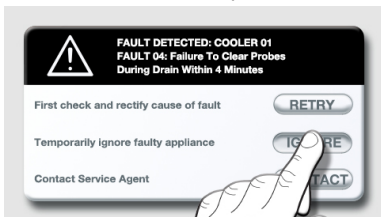

ILL1634-B

Now connect and power up the new, replacement component. The Controller will detect the new component and will give you the option to REPLACE the faulty component or install it as a new component. Choose REPLACE.



ILL1635-A

**Important!** If you are replacing more than one faulty component, it is important that new components of the same type are connected **ONE AT A TIME**.

# MANAGING COMPONENTS cont

## REMOVING COMPONENTS

If a component is to be removed from the installation and never replaced, it can be deleted from the MagIQtouch Controller's memory.

Go to the GENERAL menu in SETTINGS. Scroll down to the menu item 'SYSTEM CONFIGURATION'.



ILL1636-B

After entering the correct pin-code (7378), the Controller will do a scan to find what is connected to the system. The screen will then display a list of all components in the installation (both functional and faulty).

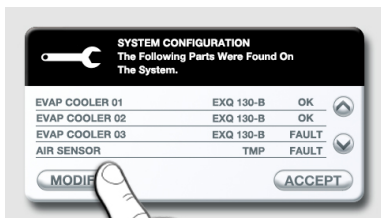

ILL1821-A



## MANAGING COMPONENTS cont

### REMOVING COMPONENTS cont

At this point, disconnect the component to be removed and press the MODIFY button. This should cause the MagIQtouch Controller to display a warning message where the component can be deleted.



ILL1638-B

**Important!** This process will permanently delete the component from the system.

If you plan to replace a faulty component with a new one in the future, then the IGNORE option on the above screen should be selected.



ILL1822-A

# MANAGING THE MAGIQTOUCH CONTROLLER

## CONNECTING A NEW CONTROLLER TO AN EXISTING SYSTEM

System configuration information is stored on the MagIQtouch Controller memory chip and cannot be transferred from one Controller to another. If a new Controller is connected to an existing system it will first need to scan the system to see what is there.

Connect the Controller to the system, ensuring all components are powered.

Choose the 'EXISTING SYSTEM WITH NEW CONTROL' option.



ILL1639-A

The MagIQtouch Controller will scan for one type of component at a time. The operator can skip to the next scan once they see all components of a particular type have been found.

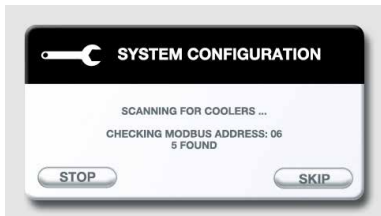

ILL1640-B

# MANAGING THE MAGIQTOUCH CONTROLLER cont

## CONNECTING A NEW CONTROLLER TO AN EXISTING SYSTEM cont

Once all components have been found the MagIQtouch Controller will display a summary list of what it has found. If this configuration is accepted, the Controller will be ready to operate the system.

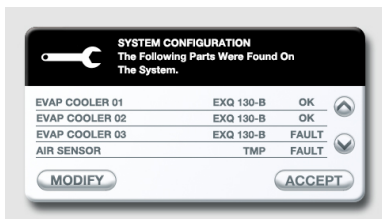

ILL1637-B

## CONNECTING A PRE-USED CONTROLLER

**Important!** Any pre-used MagIQtouch Controller must be reset before it is connected to another existing system.

Once the Controller has been reset, the installation process is the same as if it were new.

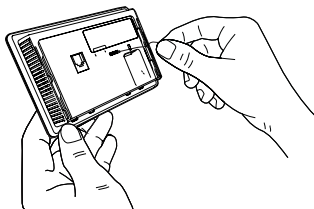

ILL1596-A

## FAULT ROUTINE

When a component in the system experiences a fault, the Controller will be notified and a fault screen will appear. The operator can then chose to resolve the issue or ignore it.

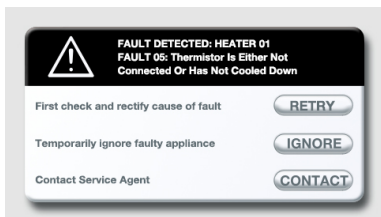

ILL1641-B

So long as a fault remains in the system, a small fault icon will be displayed at the right hand side of the lower taskbar. By pressing this icon, the operator can access information about all current faults.

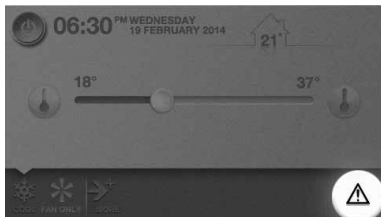

ILL1642-B

## FAULT ROUTINE cont

Faults fall into four categories:

1. Auto Reset Fault – a minor fault that is not communicated to the operator but is recorded in the fault history.
2. Running Fault - this fault allows the component to operate, with reduced functionality. If the fault is resolved, the fault icon will no longer be displayed in the lower taskbar.
3. Service Fault – a serious fault which will cause the component in question to shut down but may be resolved by the user.
4. Service Agent Fault – a serious fault which will cause the component to shut down and requires a service agent to resolve.

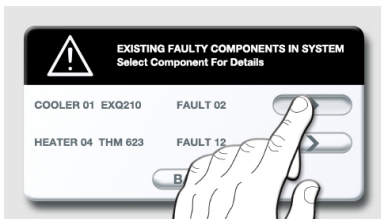

ILL1643-B



ILL1644-B

For more information on product specific fault codes, please refer to the installation manual provided with the product or contact a local service agent.

# SLAVE CONTROLLERS

Multiple MagIQtouch Controllers can be used to control individual zones. In such installations there is always one “master controller” located in a nominated “master zone”. All other controllers become “slave controllers”.

In such systems certain principles that apply:

- If the master controller is set to OFF, no other zone can be turned on.
- If the master controller is set to ON, zones can be turned on and off from the slave controllers.
- The primary operating mode (HEAT, COOL and FAN ONLY) is dictated by the master controller and cannot be changed by a slave controller.
- The SETTINGS menu in a slave controller will only display options relevant for the applicable zone.

## **For Evaporative Cooling:**

- Zoning does not apply. All zones will operate according to the temperature sensed in the “master zone”.
- The set temperature or fan speed can be modified by any controller (master or slave) but will be applied across the whole system.

## **For Gas Ducted Heating / Integrated Cooling:**

- The secondary operating mode (MANUAL and PROGRAM) can be selected for each zone from the master and slave controllers.
- The set temperature is unique for each zone and is set from the controller located within the zone (either master or slave).
- No fan speed limit control is available. Fan speed is automatically controlled by the heater to achieve the set temperature.

## POWER OUTAGES

After a power outage the MagIQtouch Controller will prompt you to enter the time and date.

If the AUTO RESTART option is switched ON in the general setting menu, the cooler or heater will automatically restart in the last mode it was running in before the outage, even before the time or date is set.

## TROUBLE SHOOTING

Symptom	Cause	Action
The MagIQtouch Controller has no display.	The cable from cooler may not be fitted correctly.	Refit cable.
	Cable damaged or broken.	Replace cable.
The MagIQtouch Controller shows the cooler/heater is on, but I can't hear the fan working.	The set temperature has been achieved and the cooler/heater is in standby.	None required. If you want to see exactly what the heater/cooler is doing, turn the "STATUS INFORMATION DISPLAY" option on in the SETTINGS menu.
	The Controller is in PROGRAM mode and the current time period specifies the cooler/heater be "OFF".	Review the schedule via the EDIT button on the PROGRAM home screen.



**Warranty Service**

Australia 1-300-650-644

**Technical Support**

Australia 1-300-650-399

**For regions outside Australia:**

Contact your local Dealer

[seeleyinternational.com](http://seeleyinternational.com)

**MANUFACTURED BY: SEELEY INTERNATIONAL PTY LTD**  
112 O'SULLIVAN BEACH RD, LONSDALE SA, 5160. AUSTRALIA

**IMPORTED BY: SEELEY INTERNATIONAL (EUROPE) LTD**  
5 PAPPLEWICK LANE, HUCKNALL, NOTTINGHAM,  
NOTTINGHAMSHIRE, NG15 7TN, UNITED KINGDOM

**SEELEY INTERNATIONAL (AMERICAS) LTD**  
1002 S 56TH AVENUE, SUITE #101,  
PHOENIX, ARIZONA 85043, USA

**SEELEY INTERNATIONAL (AFRICA) PTY LTD**  
6 WITTON ROAD, FOUNDERSVIEW SOUTH,  
MODDERFONTEIN 1609, GAUTENG, SOUTH AFRICA

It is the policy of Seeley International to introduce continual product improvement.

Accordingly, specifications are subject to change without notice.

Please consult with your dealer to confirm the specifications of the model selected.

**MAGIQTOUCH**